

EUP60D-1HMC-0 (Product No.:102100151101)

Product Features

- Signal channel output, output current level selected by DIP S.W.
- Meet DALI Protocol IEC 62386
- Support Touch DIM dimming
- THD≤15%
- Low ripple current, no flicker
- High efficiency up to 86%
- Built-in active PFC function
- Over voltage protection, short circuit protection, over power protection
- Suitable for indoor LED lighting application, such as down light, panel light, and so on



Application



Technical Parameters

Model	EUP60D-1HMC-0																		
Input	Efficiency	86%@230VAC,Full load																	
	Voltage	200VAC-240VAC																	
	Frequency Range(Hz)	50/60Hz																	
	Power Factor	≥0.9@230VAC,Full load																	
	THD(full load)	≤15%@230VAC, Full load																	
	AC Current(max)	0.4Amax@230VAC																	
	Inrush Current(max)	Cold start 27A(twidth=5.4us measured at 50% Ipeak) @230VAC																	
Output	Current(mA)/Voltage (VDC) Power(W)	1050mA/9-58VDC/60.9W 1200mA/9-50VDC/60W 1400mA/9-43VDC/60.2W																	
	Ripple Current	<4%																	
	Channel	1																	
	Current Tolerance	±3%																	
	No load output voltage	95V Max																	
	Current Selection Table																		
<table border="1"> <tr> <td></td> <td></td> <td>1</td> <td>2</td> <td></td> <td></td> </tr> <tr> <td>ON</td> <td>OFF</td> <td>1050mA</td> <td>1200mA</td> <td>1400mA</td> <td></td> </tr> <tr> <td></td> <td></td> <td>9-58V</td> <td>9-50V</td> <td>9-43V</td> <td></td> </tr> </table>				1	2			ON	OFF	1050mA	1200mA	1400mA				9-58V	9-50V	9-43V	
		1	2																
ON	OFF	1050mA	1200mA	1400mA															
		9-58V	9-50V	9-43V															
Remark: Function default setting is: 1050mA (@switch are all OFF state)																			
Function	Dimming Type	DALI /Touch DIM(Push DIM)																	
Protection	Short Circuit	Close output, recovers automatically after fault removed																	
	Over Load	When the output voltage is exceeded, the output current decreases and, recovers automatically when the load is reduced.																	
	Over voltage	Close output, recovers automatically after fault removed																	
Others	Working Temp.	-20°C~40°C																	
	Storage Temp., Humidity	-40°C~85°C, 20-90%RH																	
	tc	95°C																	
	Material	Metal																	
	IP Rating	IP20																	
	Lifetime	30,000h@tc:75°C																	
	Warranty Condition	3 Years																	
	Switch Cycle	>15,000 times																	
	Packing(weight)	Net weight: 410g±5%/PCS; 30PCS/Carton;12.8kg±5%/Carton; Carton Size: 383*222*217mm(L*W*H)																	
Dimension	203*54*33mm(L*W*H)																		

Dimension(mm)

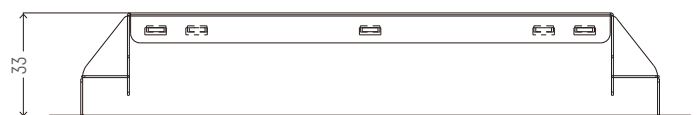
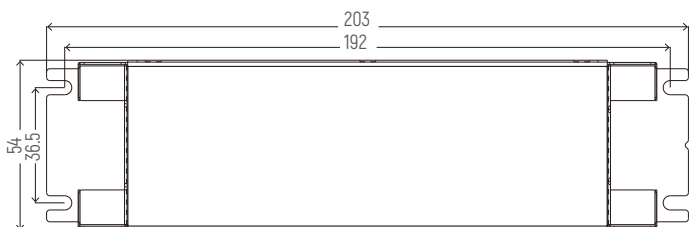

DALI Wiring

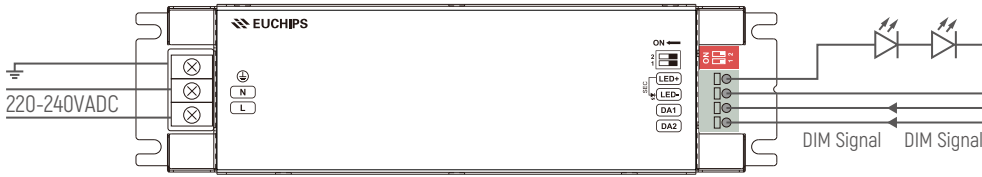

DALI Diagram

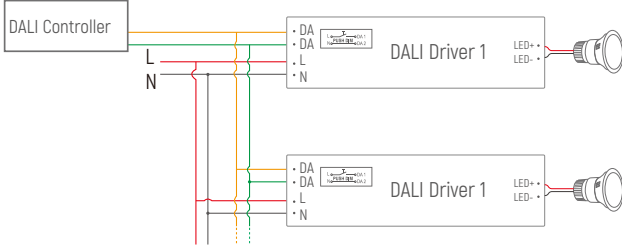

Push DIM(Touch DIM) Diagram

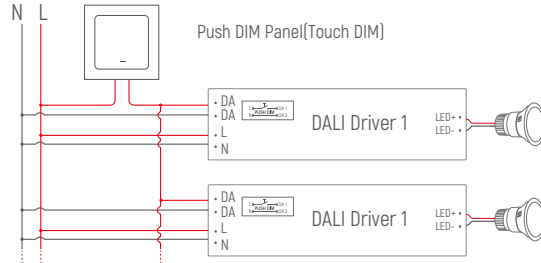

Remark: Only use open push button without indicator light. Maximum cable length between each Unit: 20 meters.

Push DIM Function

1. Short press the Touch DIM switch (<0.5s) to control the lamp on or off.
2. Long press the Touch DIM switch (>0.5s) to dim the brightness of light. The dimming direction will change every time after pressing switch.
3. Double-click the Touch DIM switch (<0.3s), then all lamps connected on the device will be set maximum brightness.
4. The brightness adjustment range is 1%-100%, and the light can be turned off through short pressing when doing the adjustment with long pressing Touch DIM switch.
5. With the Power off memory function, the power-down state will be recovered when power on again.

Cautions

- 1.This product should be installed by qualified personnel.
- 2.DALI and Touch-DIM functions can not be used at the same time.
- 3.This product is non waterproof, need to avoid sun and rain.In case of outdoor use, please ensure it is mounted in a water proof enclosure.
- 4.Good heat dissipation conditions extend product life. Please install the product in a well-ventilated environment.
- 5.Please make sure LED power supply output voltage, current is used to meet the product requirements.
- 6.Please ensure that adequate sized cable is used from the controller to the LED lights to carry the current. Please also ensure that the cable is secured tightly in the connector.
- 7.Due to safety concerns, PVC or rubber cord of 0.75-2.5mm² is recommended for input and output terminal(s) (excluding signal terminals). Flat power cord is not suitable.Ensure all wire connections and polarities are correct before applying power to avoid any damages to the LED lights.
- 8.In case of malfunction, do not repair it yourself.

※ The contents of this manual are updated without prior notice. If the function of the product you are using is inconsistent with the instructions, the function of the product shall prevail.Please contact us if you have any questions .

EUP60D-1HMC-0 (产品代码:102100151101)

产品特点

- 单通道输出, 多级电流输出可选
- 遵循DALI 协议标准IEC62386
- 支持Touch DIM 功能
- THD≤15%
- 低纹波电流, 无频闪
- 高效率达: 86%
- 内建主动式PFC 功能
- 过载保护; 输出短路保护; 输出过压保护
- 适用于LED 室内灯具,比如筒灯, 面板灯等



应用



技术参数

型号	EUP60D-1HMC-0		
输入	效率	86%@230VAC, 满载	
	电压	200VAC-240VAC	
	频率	50/60Hz	
	功率因素	≥0.9@230VAC, 满载	
	THD	≤15%@230VAC, 满载	
	电流	0.4Amax@230VAC	
	待机功耗	<0.5W	
	浪涌电流	冷启动27A (在50%Ipeak 下测试twidth=5.4us) @230VAC	
输出	电流/电压/功率	1050mA/9-58VDC/60.9W 1200mA/9-50VDC/60W 1400mA/9-43VDC/60.2W	
	波纹电流	<4%	
	通道	1	
	电流精度	±3%	
	最大输出电压	95V Max	
	启动延时	<1.5s, at230Vac	
功能	调光方式	DALI/Touch DIM(Push DIM)	
	保护	短路	关断输出, 移除故障后自恢复
		过载	超过输出电压时, 输出电流下降,减轻负载自动恢复
其它	过压	关断输出, 移除故障后自恢复	
	工作温度	-20°C~40°C	
	储存温度、湿度	-40°C~85°C, 20-90%RH	
	tc	95°C	
	材质	金属	
	防水等级	IP20	
	寿命	30,000小时@tc:75°C	
	质保	3年	
	开关周期	>15,000次	
	包装尺寸(重量)	净重: 410g±5%/PCS; 30PCS/Cartron; 12.8kg±5%/箱; 外箱尺寸: 383*222*217mm(长*宽*高)	
尺寸	203*54*33mm (长*宽*高)		

电流选择表

ON	OFF	1	2	1050mA	1200mA	1400mA
				9-58V	9-50V	9-43V

备注: 出厂默认设置电流为1050mA (1,2在OFF状态)

尺寸(mm)

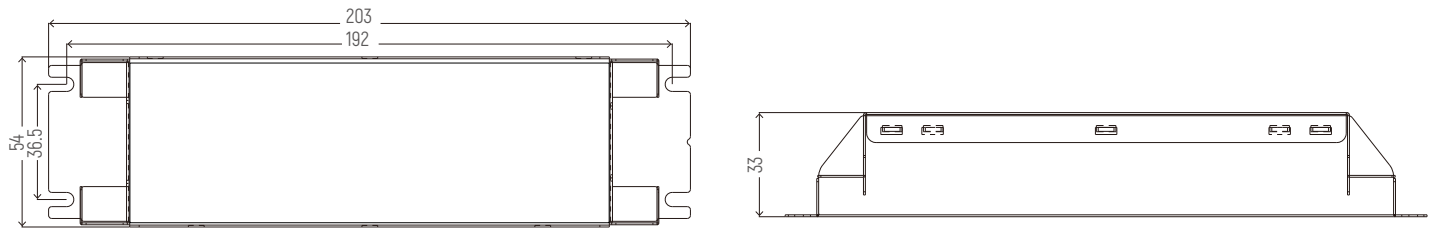

接线图

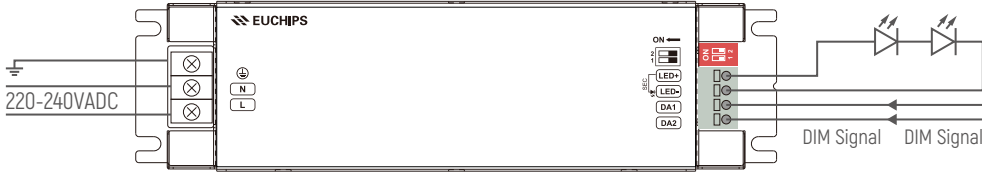

DALI应用图

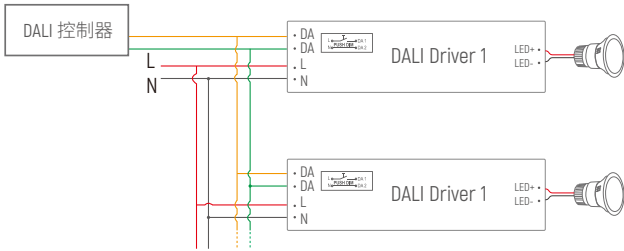

Push DIM (Touch DIM)应用图

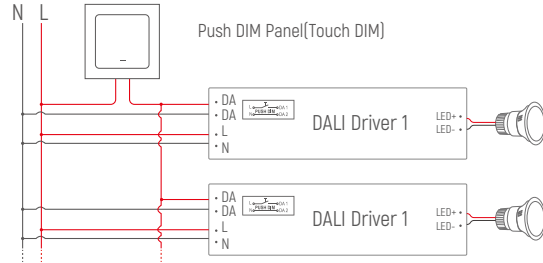

备注: 只能使用开路的按压式开关(不带指示灯). 采用同步连线时每个设备和设备之间的线长不超过20米.

Push DIM 功能

1. 短按Touch DIM 开关(<0.5 秒) 进行灯的亮暗控制。
2. 长按Touch DIM 开关(>0.5 秒) 进行灯具的亮度调节, 光是调亮还是调暗, 随着每次按压的开关变化而变换。
3. 双击Touch DIM 开关 (<0.3 秒), 连接的所有灯具将达到最亮状态。
4. 亮度调节范围为1%-100%。
5. 具有断电记忆功能, 重新上电将恢复到上一次断电的状态。

注意事项

1. 本产品请由具有专业资格的人员进行调试安装。
2. DALI 和Touch-DIM 功能不能同时使用。
3. 本产品不能防水, 需避免日晒雨淋, 如安装在户外, 请用防水箱。
4. 良好的散热条件会延长产品的使用寿命, 请把产品安装在通风良好的环境。
5. 请检查使用的LED电源输出电压电流, 是否符合产品要求。
6. 出于安全考虑, 推荐输入和输出(信号端除外)用0.75-2.5mm² PVC或橡胶线缆, 并确保接线牢固, 以免电线过热或接触不良触发事故。扁平电源线不适用。
7. 通电调试前, 应确保所有接线正确, 以避免因接线错误而导致灯具损坏。
8. 如果发生故障, 请勿私自维修; 如有疑问, 请联系供应商。

※ 本说明书内容如有更新, 恕不另行通知。若您使用的产品功能与说明书不一致时, 请以产品为准。如有疑问请与我们联系。